

AFCO Installation & Operation Instructions

Model #AF 950001-B •633 Compact Fogger

REQUIREMENTS

Ready-to-Use Chemical Solution

Compressed Air	3.7 CFM @ 80 PSI
Minimum Air Supply Line	3/8"

OPTIONS

Stainless Steel Hose Racks

Large	# 224150
Small	# 224145

Proportioning / Filling Options

1-Way Ball Valve Mixing Station (4 GPM)	# 985100
1-Way Push Lever Mixing Station (4 GPM)	# 981100

WEIGHT & DIMENSIONS

Shipping Weight: 2 lbs.

Shipping Dimensions: 7" x 7" x 7"



AFCO
<http://www.afcocare.com>

**READ ALL
INSTRUCTIONS BEFORE
USING EQUIPMENT!**

Overview

The 633 Compact Fogger is a chemical atomizer that uses compressed air (3.7 CFM @ 80 PSI) to draw pre-diluted chemical solution from the attached 22 oz. bottle, atomize the chemical and project it as small to medium sized fog particles at distances up to 15 feet. Used for sanitizing, insecticide application, odor control, humidification and many other applications.

AFCO • 5000 Letterkenny Rd • Chambersburg, PA. 17201 • 1-800-345-1329



Safety & Operational Precautions

- Manufacturer assumes no liability for the use or misuse of this unit.
- Wear proper respiratory protection, protective clothing, gloves and eye-wear when working with chemicals.
- Always direct the discharge away from electrical devices.
- Follow the chemical manufacturer's safe handling instructions.
- NEVER fog flammable materials through the fogger.
- **SPECIAL CAUTION: This fogger atomizes chemical into the air. Ensure that the area to be fogged has been evacuated of all people without proper respiratory protection!**

TO INSTALL (REFER TO DIAGRAM, NEXT PAGE.)

TO OPERATE

SPECIAL CAUTION: This fogger atomizes chemical into the air. Ensure that the chemical is safe to be around or the area to be fogged has been evacuated of all people and/or animals before starting fogging. Upon completion of fogging, ensure that sufficient time has elapsed for all the fog to have dissipated before returning to the area. Wear proper respiratory protection, protective clothing, gloves and eye-wear when working with chemicals

1. Unscrew the bottle, add ready to use chemical bottle and re-attach.
2. Don't over tighten.
3. Connect the trigger gun to a compressed airline.
4. Direct the discharge in a safe direction. Pull the trigger to begin application.
5. When application is complete, release the trigger.
6. The fogger may produce more fog volume than needed.
7. If fog is too dense, metering tips are included for restricting the solution volume to produce a lighter fog.
8. Make final metering tip adjustments based on application results. Try the next larger sized metering tip until the results are acceptable.

633 Fogger
Project medium to small fog
particles up to 12 feet.

COMPRESSED AIR FLOW IN CFM

MODEL	60 PSI	80 PSI
1-WAY	3.0	3.7

CHEMICAL SOLUTION DRAW RATE

Average ounces of chemical solution per minute the fogger will draw

	13.3	13.7
--	------	------

Metering Tip Selection Chart

Metering Tip Color	Oz. per Min.
Brown	.56
Clear	.88
Bright Purple	1.38
White	2.15
Pink	2.93
Corn Yellow	3.84
Dark Green	4.88
Orange	5.77
Gray	6.01
Light Green	7.01

The Oz. per Minute shown are approximate. Due to chemical viscosity, actual Oz. per Minute may vary.

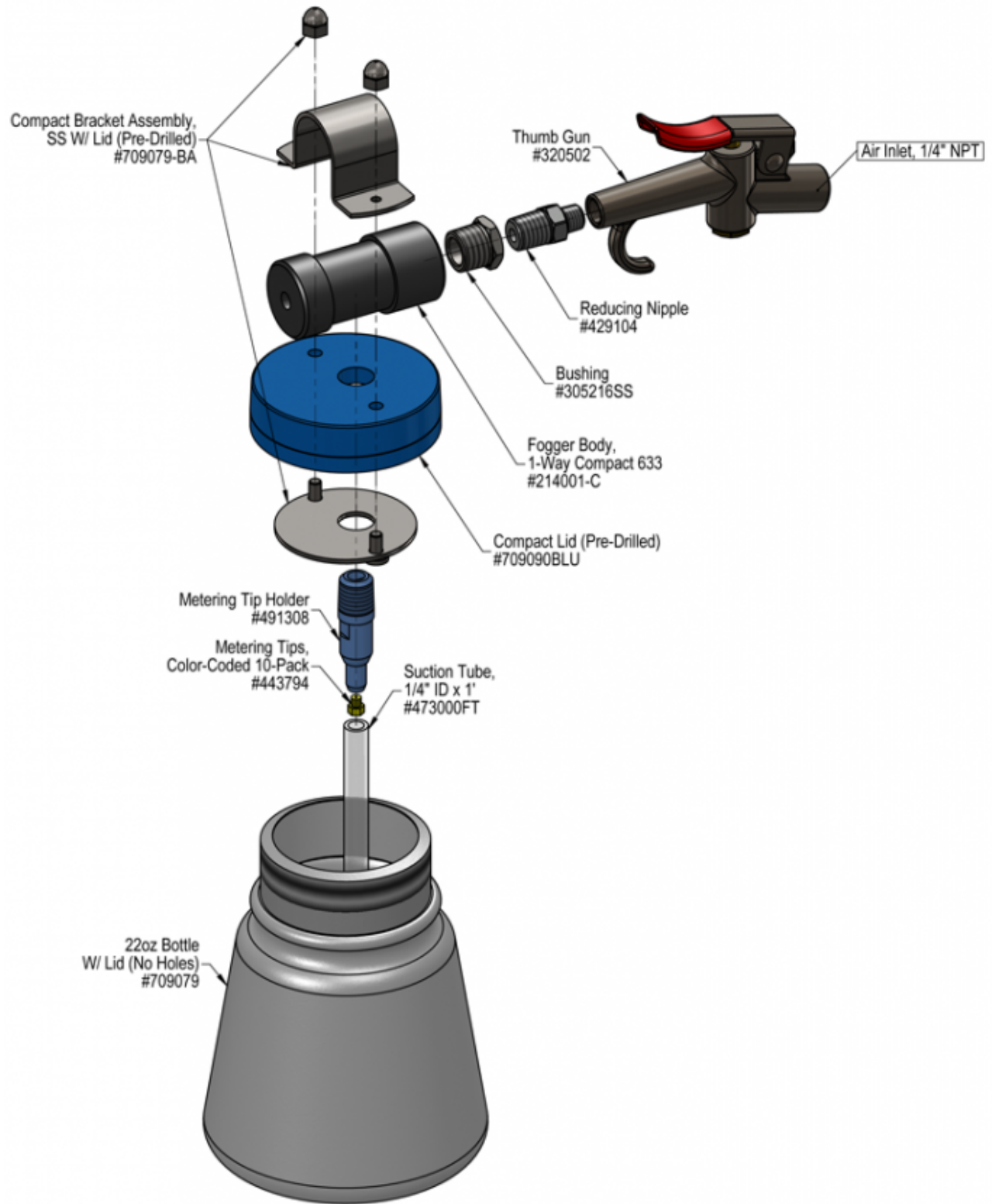

Troubleshooting Guide

AF 950001-B • 633 Compact Fogger

Problem	Possible Cause / Solution	
	Startup	Maintenance
A) Fogger will not draw chemical or is sputtering	1, 2, 3, 4	6, 7, 8
B) Fog is too wet	1, 4	5

Possible Cause / Solution	
Startup	Maintenance
<ol style="list-style-type: none"> 1. Air line too small, not enough air pressure or volume <ul style="list-style-type: none"> ◦ See REQUIREMENTS, page 1. 2. Air pressure too high. <ul style="list-style-type: none"> ◦ Slightly close the air supply valve to lower the pressure by lowering the volume till the fogger smooths out. 3. Chemical tube kinked or not immersed in chemical or chemical depleted. <ul style="list-style-type: none"> ◦ Straighten tube / replenish chemical 4. Drawing too much solution <ul style="list-style-type: none"> ◦ Install optional metering tip 	<ol style="list-style-type: none"> 5. Pin hole or cut in suction tube <ul style="list-style-type: none"> ◦ Replace suction tube. 6. Chemical tube clogged up <ul style="list-style-type: none"> ◦ Clean or replace 7. Metering tip or metering tip holder clogged <ul style="list-style-type: none"> ◦ Clean or replace metering tip and/or metering tip holder. 8. Debris clogging the fogger inlet jets <ul style="list-style-type: none"> ◦ Disconnect air supply, remove fogger bodies and visually inspect; remove debris from fogger inlet.

PREVENTIVE MAINTENANCE: When the unit will be out of service for extended periods, place chemical tube(s) in water and flush the chemical out of the unit to help prevent chemical from drying out and causing build-up. Periodically check and clean chemical strainer and replace if missing.

